



High feed milling cutter

ADD^DFEED

Tungaloy Report No. 545S1-G

High feed milling modular cutter head
in diameters as small as **8 mm**

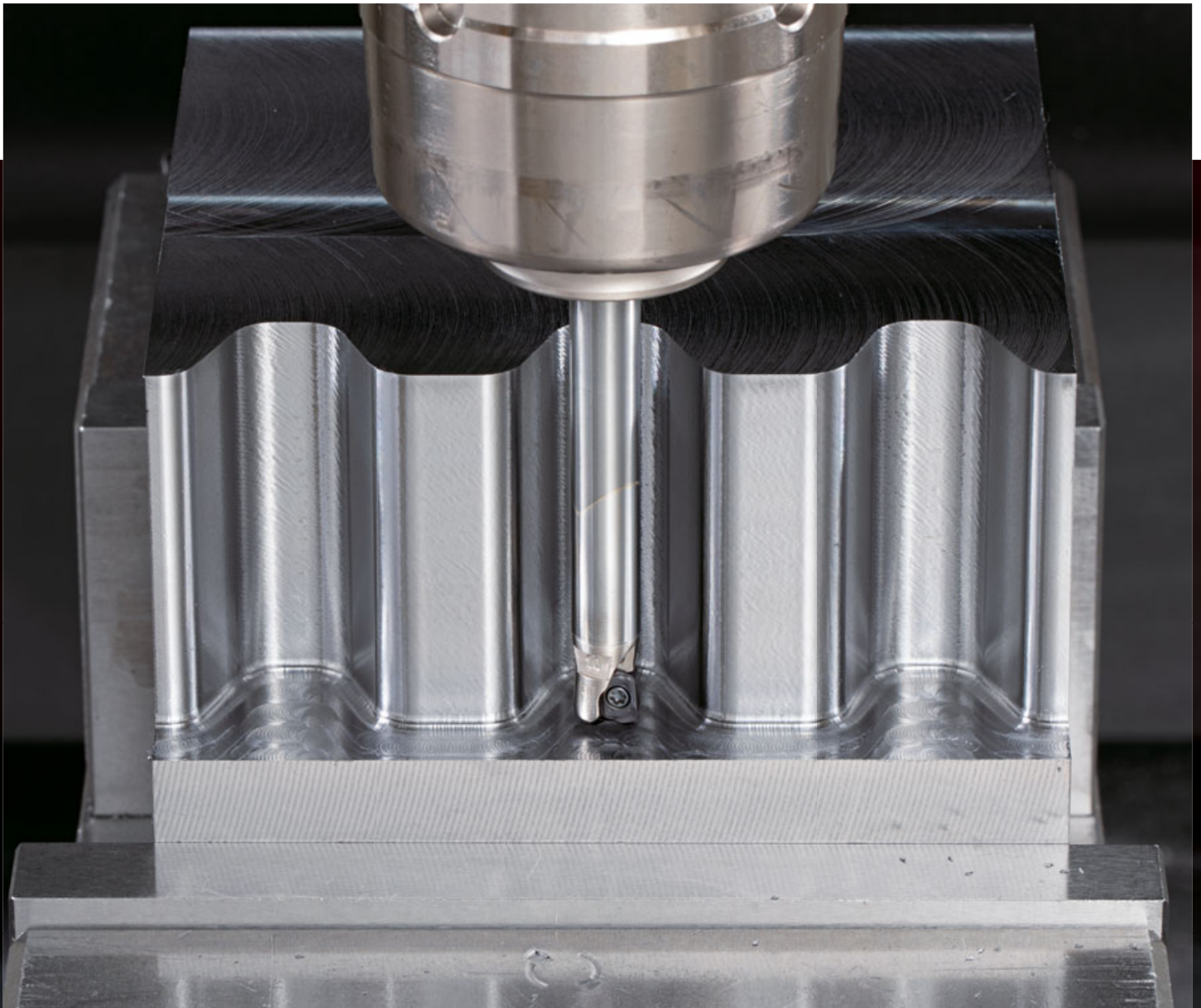

High feed milling cutter with excellent tool stability in long overhang machining

HXN02R

High feed endmill, modular type (TungMeister)

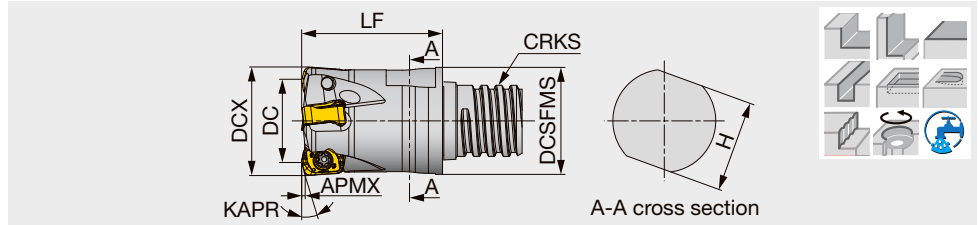

Designation	APMX	DCX	CICT	DC	DCSFMS	LF	H	KAPR	CRKS	WT(kg)	Air hole	Insert
HXN02R008MS05-01	0.5	8	1	3.97	7.6	10	5.5	17	S05	0.004	With	LNMU0202...
HXN02R010MS06-02	0.5	10	2	5.88	9.6	16	8	17	S06	0.01	With	LNMU0202...
HXN02R012MS08-02	0.5	12	2	7.8	11.5	18	10	17	S08	0.01	With	LNMU0202...
HXN02R016MS10-04	0.5	16	4	11.8	15.2	20	13	17	S10	0.03	With	LNMU0202...

SPARE PARTS

Designation	Clamping screw	Wrench 1	Wrench 2
HXN02R008MS05...	CSPB-1.8FL3.6	IP-6DB	KEYV-S05
HXN02R010MS06...	CSPB-1.8FL4.3	IP-6DB	KEYV-S06
HXN02R012MS08...	CSPB-1.8FL4.3	IP-6DB	KEYV-S08
HXN02R016MS10...	CSPB-1.8FL4.3	IP-6DB	KEYV-S10

Tool diameter tolerance	
Tool diameter	0 / -0.4

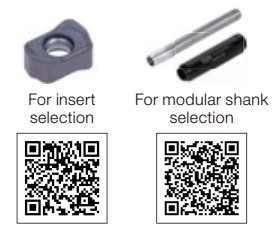

Note : Dedicated wrench is sold separately.

*Recommended clamping torque (N·m) : CSPB-1.8FL3.6, CSPB-1.8FL4.3 = 0.5
KEYV-S05 = 7, KEYV-S06 = 10, KEYV-S08 = 15, KEYV-S10 = 28

APPLICATION RANGE

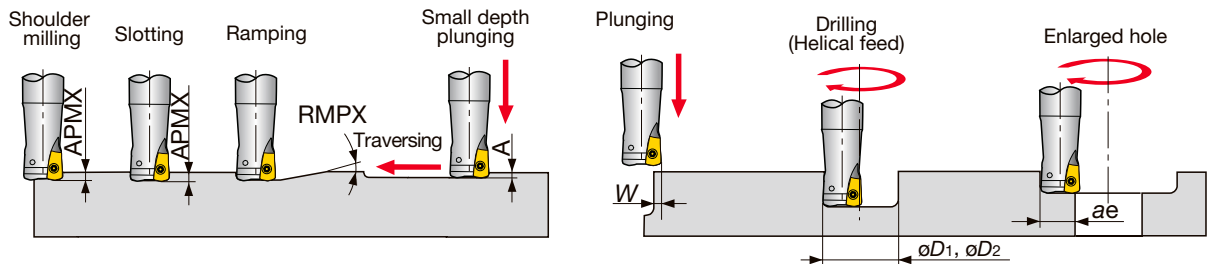

Designation	DCX	Max. depth of cut	Max. ramping angle	Max. plunging depth	Max. cutting width in plunging	Min. machining	Max. machining	Max. cutting width in enlarged hole
		APMX	RMPX	A	W	ϕD_1	ϕD_2	ae
HXN02R008MS05-01	8	0.5	0.5	0.03	2	11.5	13.2	5.87
HXN02R010MS06-02	10	0.5	2.8	2.8	2	13.8	17	7.82
HXN02R012MS08-02	12	0.5	1.9	1.9	2	17.8	21	9.81
HXN02R016MS10-04	16	0.5	1.2	1.2	2	25.8	29	13.8



tungaloy.com

follow us at:
facebook.com/tungaloyjapan
twitter.com/tungaloyjapan
www.youtube.com/tungaloycorporation

Distributed by:



FIND US ON THE CLOUD!
machiningcloud.com



AS9100 Certified
78006
2015.11.04
ISO 14001 Certified
EC97J1123
1997.11.26