

带有简易微调机构的精镗头系统





134.5-010

SWISS
TOOLS

3 Nm

1mm
1mm
1mm
579°
854°
004°

QJAF000

00.000mm

MM

倍速加工



没有齿间间隙的高精度直径调节机构。简易数显窗口。

变化范围大的快换系统

DIN69871A/D

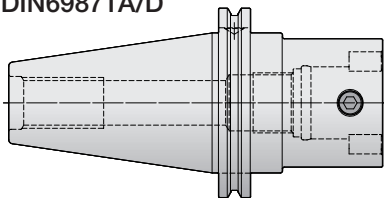

ANSI B5.50(CAT)

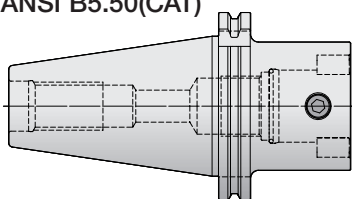

MAS-BT

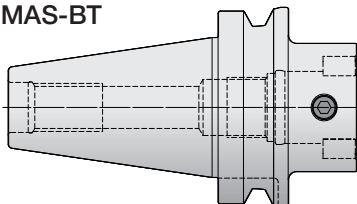

DIN69893(HSK A)

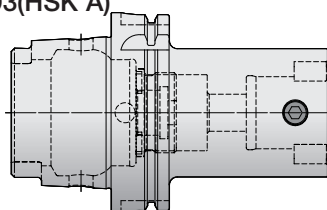

ISO26623-1(PSC)

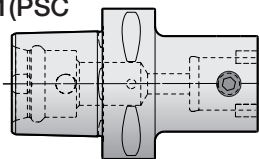

SK50 BT50

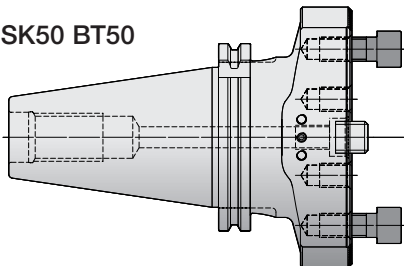

HSK-A100

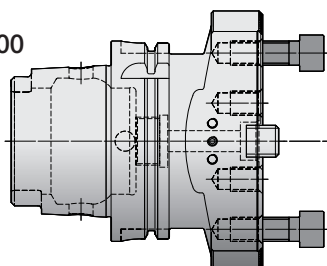

减径柄

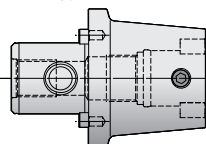

延长柄

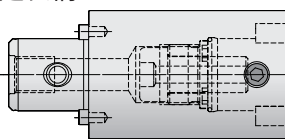

桥镗刀体

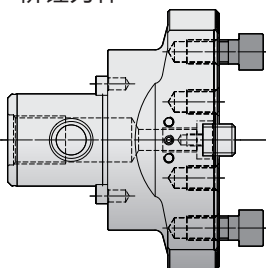

双镗头镗刀
镗头444

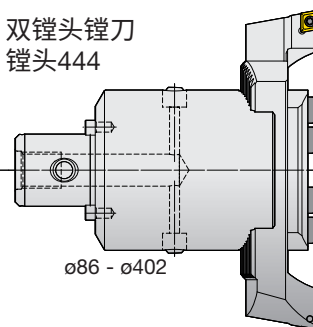

ø86 - ø402

双镗头镗刀
镗头404

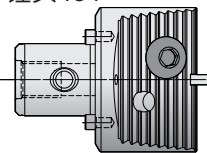

ø23.5 - ø153

延长柄桥镗

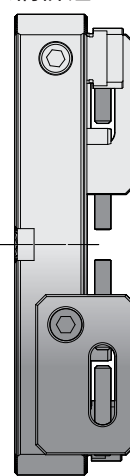

ø150 - ø2205

镗头
570, 575, 580

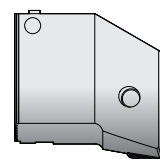
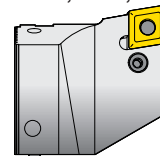

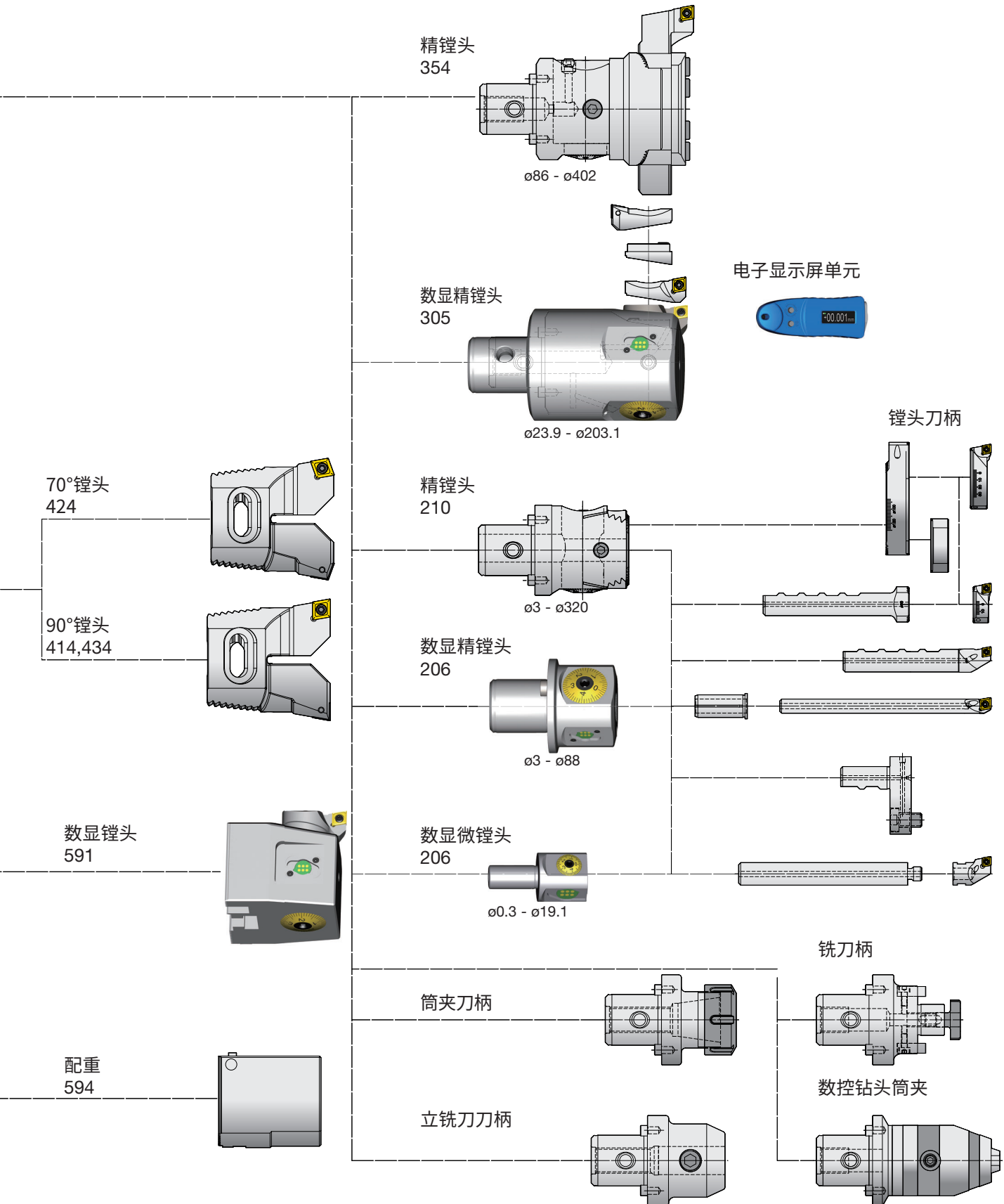

数显精镗头

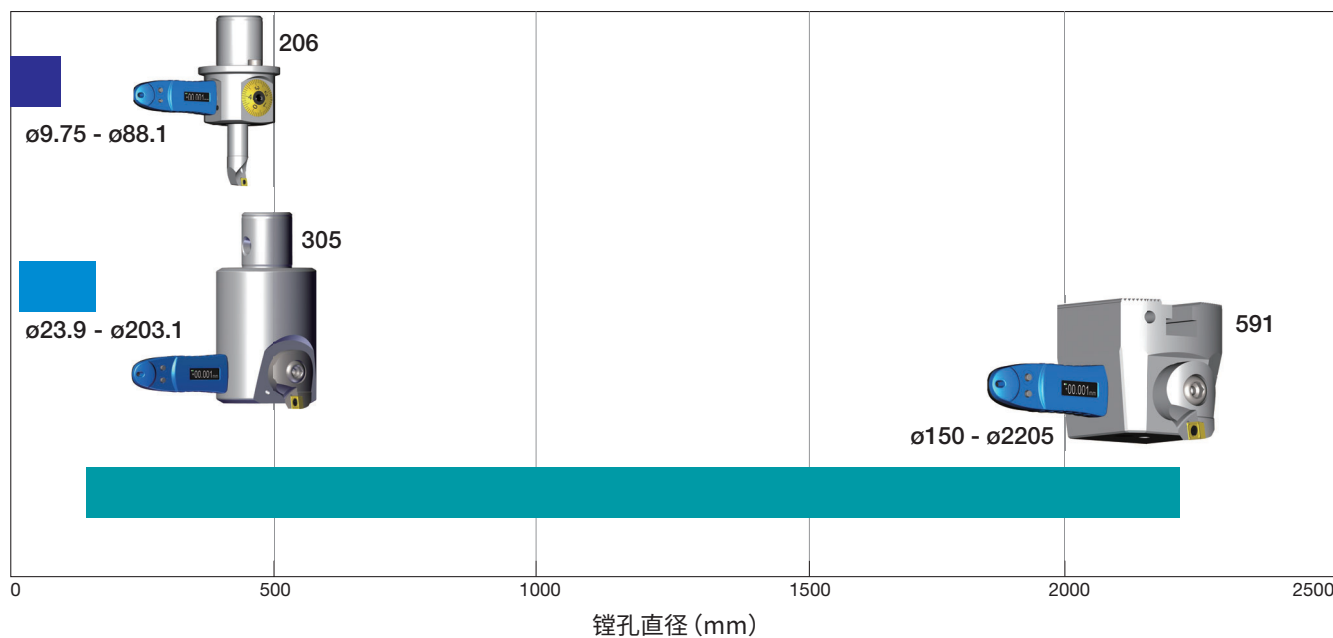

粗镗刀头

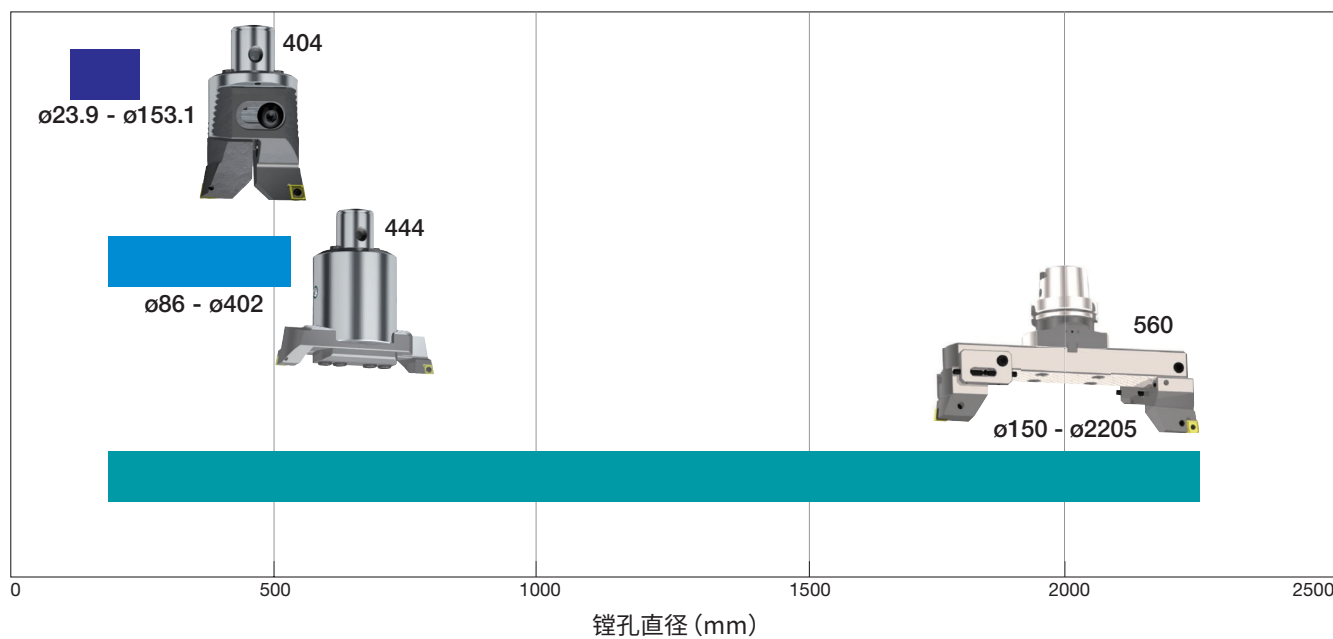

高刚性快换连接系统

ST 型

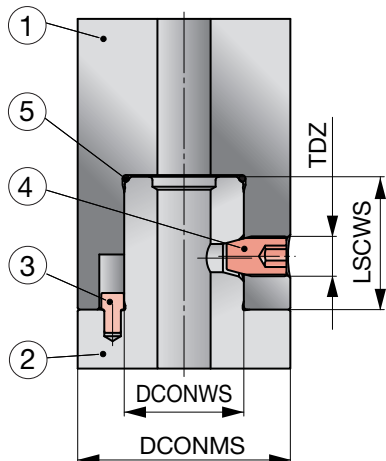

公导向器②放置到插座①中并由径向锁紧螺钉④锁紧。大的接触表面和高预应力提供高刚性。两个驱动栓③确保准确的刀尖方向，另外用于驱动。在插座的底座上安装一个 o 形环⑤。

ST+ 型用于重切削

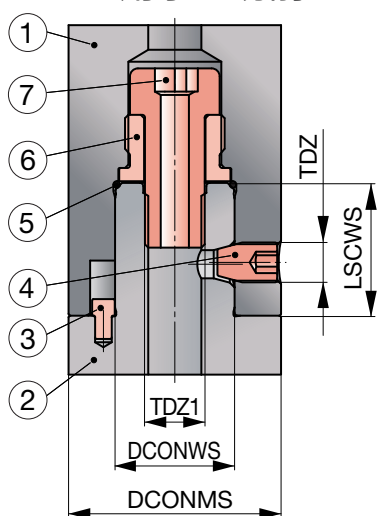

ST+ 一个额外的特点是能够用于重型切削。通过使用一个膨胀螺钉⑦极大地提高了能够使刚性最大化的恢复应力。这个膨胀螺钉⑦通过螺纹环⑥安装在插座上。

仅在极端切削条件下才会使用膨胀螺钉⑦的系统元件锁紧方式。因此 ST+- 提供的组件不包括这个膨胀螺钉⑦和螺纹环⑥。这些配件需要单独订购并且由客户组装。

连接尺寸	直径 (mm)			TDZ	扭矩 (N.m)	TDZ1
	DCONMS	DCONWS	LSCWS			
ST1	20	11	13	M4 x 0.5	2.5	-
ST2	25	14	16	M5 x 0.5	3	-
ST3	32	18	20	M6 x 0.75	5	-
ST4	39	22	24	M8 x 0.75	10	-
ST5	50	28	30	M10 x 1	20	-
ST6 / ST6+	64	36	40	M12 x 1	40	M18 x 2
ST7+	90	46	50	M20 x 1.5	60	M24 x 2

精镗头系统在机床上进行微米级调节变得简单

带数字显示屏的精镗头

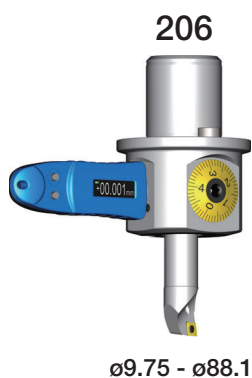

- 调整精度高，直径方向上 0.001mm 可调。
- 简易数显单元。简单固定在刀体上显示精确的刀具直径同时安装在机床上。
- 直接测量系统没有齿间间隙。
- 经济型数显单元可与全数显精镗头一起使用。
- 内冷供给系统提高了切屑控制能力。

GH1-DA

电子显示屏单元



型号

GH1-DA2.BG0.077

高精度数显单元直径精度 0.001mm。显示单元的特点是直接测量没有齿间间隙。灯光显示器可以 180 度旋转以适应任何测量环境。

mm/inch 可切换

安装标准 AAA 电池。

磁力座

备件

型号	锁紧螺钉①	螺钉扳手	电池②
GH1-DA2.BG0.077	900.309.022.008	900.308.011.045	AAA

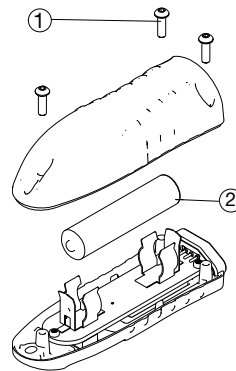

SwissBore206

数显精镗头 $\varnothing 9.75 - \varnothing 88.1$

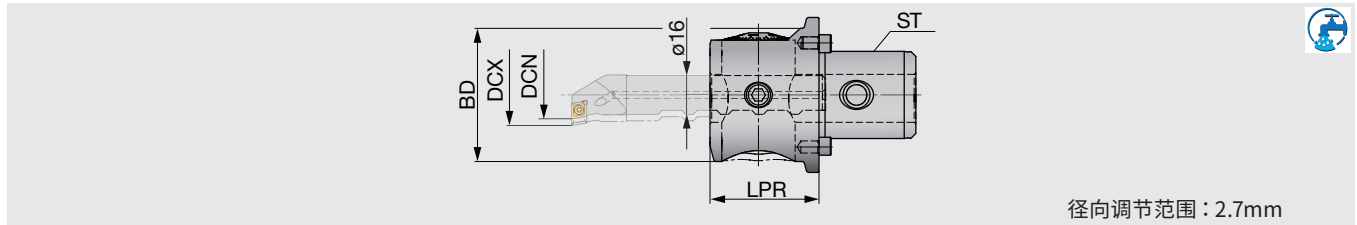

径向调节范围：2.7mm

型号	ST	BD	DCN	DCX	LPR
206.064.025.045	ST6	55	9.75	88.1	45

备件

型号	驱动栓①	锁紧螺钉②	紧固螺钉③
206.***.025.***	900.102.064.000	900.204.010.008	900.204.010.008

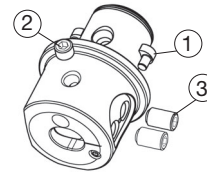

镗杆 254,256
选装配件：显示单元 GH1-DA2.BG0.077

SwissBore254

镗杆 $\varnothing 9.75 - \varnothing 30.1$

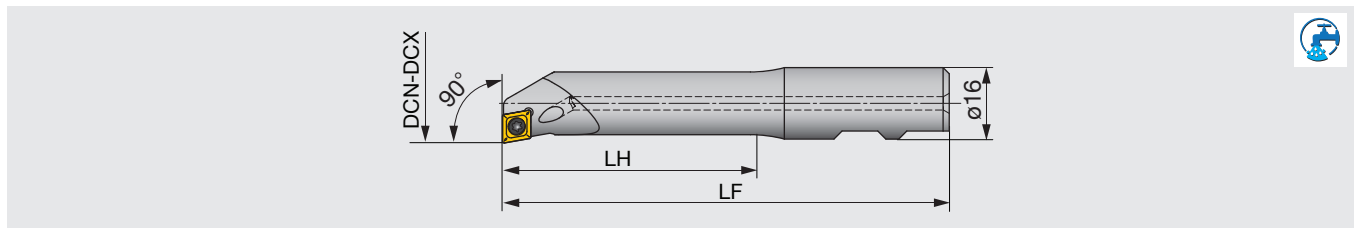

型号	DCN	DCX	LH	LF	刀片
254.010.006.075	9.75	15.1	30	75	CC**0602...
254.015.006.090	14.75	20.1	51	90	CC**0602...
254.020.006.105	19.75	25.1	72	105	CC**0602...
254.025.006.115	24.75	30.1	82	115	CC**0602...

适用于 7MPa 的高压冷却

备件

型号	锁紧螺钉	扳手
254.0**.006.**	CSTB-2.5S	T-8F

SwissBore256

镗杆 $\varnothing 29.75 - \varnothing 88.1$

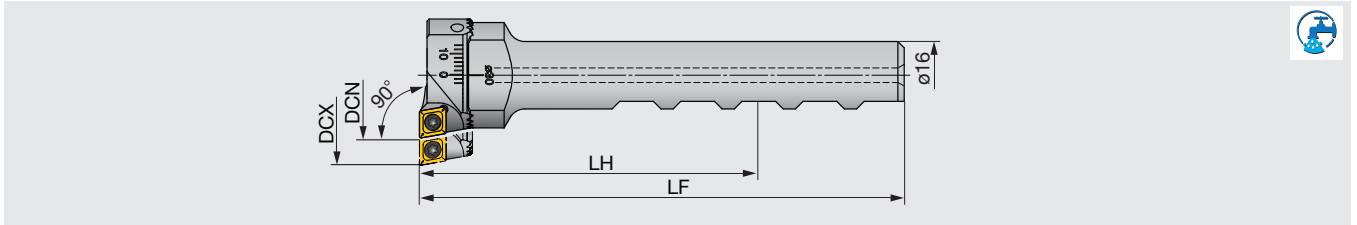

型号 (柄)	型号 (镗头)	DCN	DCX	LH	LF	刀片
256.030.048.115	256.030.006.012	29.75	48.1	85	115	CC**0602...
256.048.088.115	256.048.006.014	47.75	88.1	85	115	CC**0602...

适用于 7MPa 的高压冷却

备件

型号	紧固螺钉①	锁紧螺钉②	扳手③
256.0**.006.0**	900.256, 005.016	CSTB-2.5S	T-8F

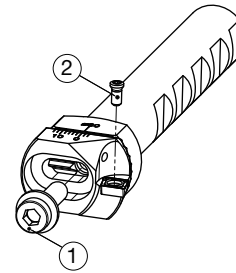

SwissBore305

数显精镗头 $\varnothing 23.9 - \varnothing 203.1$

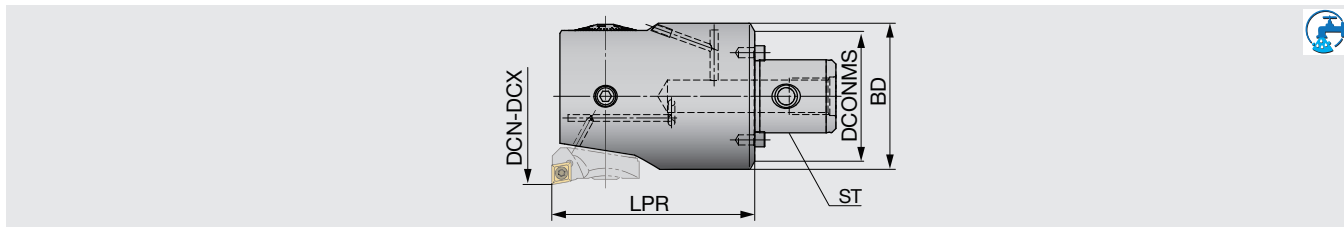

型号	ST	DCN	DCX	DCONMS	BD	LPR	镗头
305.020.024.035	ST1	23.9	31.1	20	20	35.5	314.011.024.006/007
305.020.024.035	ST1	29.9	37.1	20	20	35.5	314.011.030.006/007
305.025.031.040	ST2	30.9	40.1	25	25	40	314.013.031.006/007
305.025.031.040	ST2	30.9	47.1	25	25	40	314.013.038.006/007
305.032.040.047	ST3	39.9	51.1	32	32	47	314.017.040.006/007
305.032.040.047	ST3	47.9	59.1	32	32	47	314.017.048.006/007
305.039.051.057	ST4	50.9	67.1	39	42	57	314.022.051.006/007
305.039.051.057	ST4	64.9	81.1	39	42	57	314.022.065.006/007
305.050.067.080	ST5	66.9	87.1	50	55	80	314.030.067.009/011
305.050.067.080	ST5	84.9	105.1	50	55	80	314.030.085.009/011
305.064.087.100	ST6+	86.9	116.1	64	72	100	314.030.067.009/011
305.064.087.100	ST6+	104.9	134.1	64	72	100	314.030.085.009/011
305.090.116.130	ST7+	115.9	153.1	90	94	130	314.030.067.009/011
305.090.116.130	ST7+	133.9	171.1	90	94	130	314.030.085.009/011
305.090.116.130	ST7+	153.9	191.1	90	94	130	314.726.003.009/011
305.090.116.130	ST7+	165.9*	203.1*	90	94	130	-

选装配件：刀片刀柄（314.726.003.009 或者 314.726.003.011） & 刀盘（900.803.001.006）
适用于 7MPa 的高压冷却

备件

型号	驱动栓①	锁紧螺钉②	刀具锁紧螺钉③
305.020.024.035	900.102.020.000	900.304.004.003	900.314.004.006
305.025.031.040	900.102.025.000	900.304.005.004	900.314.005.008
305.032.040.047	900.102.032.000	900.304.006.005	900.314.006.010
305.039.051.057	900.102.039.000	900.304.008.006	900.314.008.012
305.050.067.080	900.102.050.000	900.304.010.010	900.314.010.016
305.064.087.100	900.102.064.000	900.304.010.018	900.314.010.016
305.090.116.130	900.102.090.000	900.304.010.030	900.314.010.016

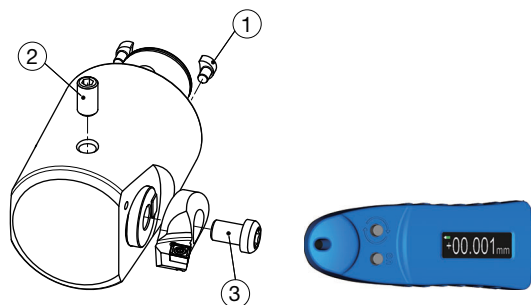

SwissBore314

使用 CC** 刀片的 90°角镗头

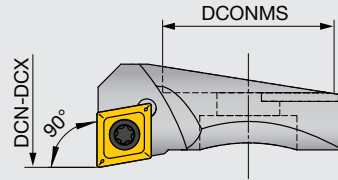

型号	DCN	DCX	DCONMS	刀片	镗头
314.011.024.006	23.9	31.1	11	CC**0602**	305.020.024.035
314.011.030.006	29.9	37.1	11	CC**0602**	305.020.024.035
314.013.031.006	30.9	40.1	13	CC**0602**	305.025.031.040
314.013.038.006	37.9	47.1	13	CC**0602**	305.025.031.040
314.017.040.006	39.9	51.1	17	CC**0602**	305.032.040.047
314.017.048.006	47.9	59.1	17	CC**0602**	305.032.040.047
314.022.051.006	50.9	67.1	22	CC**0602**	305.039.051.057
314.022.065.006	64.9	81.1	22	CC**0602**	305.039.051.057
314.030.067.009	66.9	87.1	30	CC**09T3**	305.050.067.080
314.030.085.009	84.9	105.1	30	CC**09T3**	305.050.067.080
314.030.067.009	86.9	116.1	30	CC**09T3**	305.064.087.100
314.030.085.009	104.9	134.1	30	CC**09T3**	305.064.087.100
314.030.067.009	115.9	153.1	30	CC**09T3**	305.090.116.130
314.030.085.009	133.9	171.1	30	CC**09T3**	305.090.116.130
314.726.003.009	153.9	191.1	30	CC**09T3**	305.090.116.130

备件

型号	锁紧螺钉①	扳手②
314.***.***006	CSTB-2.5S	T-8F
314.***.***009	CSTB-4S	T-15F

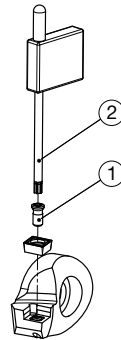

SwissBore314

使用 TP** 刀片的 90°角镗头

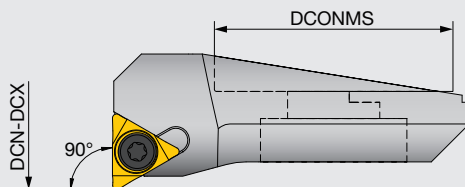

型号	DCN	DCX	DCONMS	刀片	镗头
314.011.024.007	23.9	31.1	11	TP**0701**	305.020.024.035
314.011.030.007	29.9	37.1	11	TP**0701**	305.020.024.035
314.013.031.007	30.9	40.1	13	TP**0701**	305.025.031.040
314.013.038.007	37.9	47.1	13	TP**0701**	305.025.031.040
314.017.040.007	39.9	51.1	17	TP**0701**	305.032.040.047
314.017.048.007	47.9	59.1	17	TP**0701**	305.032.040.047
314.022.051.007	50.9	67.1	22	TP**0701**	305.039.051.057
314.022.065.007	64.9	81.1	22	TP**0701**	305.039.051.057
314.030.067.011	66.9	87.1	30	TP**1102**	305.050.067.080
314.030.085.011	84.9	105.1	30	TP**1102**	305.050.067.080
314.030.067.011	86.9	116.1	30	TP**1102**	305.064.087.100
314.030.085.011	104.9	134.1	30	TP**1102**	305.064.087.100
314.030.067.011	115.9	153.1	30	TP**1102**	305.090.116.130
314.030.085.011	133.9	171.1	30	TP**1102**	305.090.116.130
314.726.003.011	153.9	191.1	30	TP**1102**	305.090.116.130

备件



型号	锁紧螺钉①	扳手②
314.***.***007	CSTB-2.2L038	T-7F
314.***.***011	CSTB-2.5S	T-8F

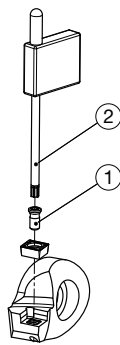

SwissBore134

主柄刀柄 MAS-BT

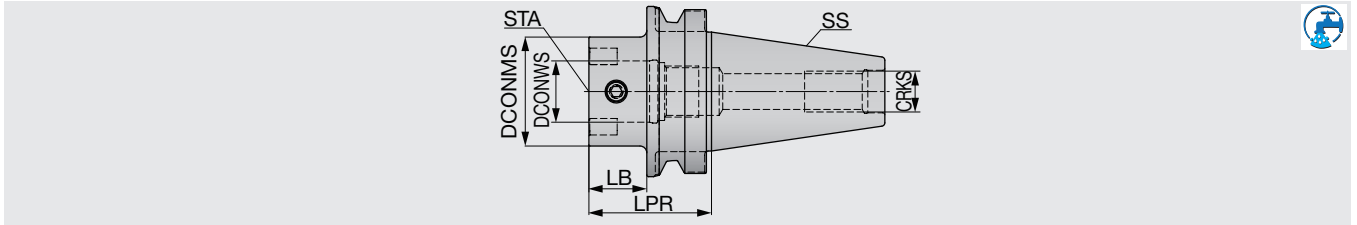

型号	SS	STA	DCONMS	DCONWS	LPR	LB	CRKS
134.530.050.038	BT30	ST5	50	28	38	16	M12
134.540.020.042	BT40	ST1	20	11	42	15	M16
134.540.025.042	BT40	ST2	25	14	42	15	M16
134.540.032.044	BT40	ST3	32	18	44	17	M16
134.540.039.048	BT40	ST4	39	22	48	21	M16
134.540.050.055	BT40	ST5	50	28	55	28	M16
134.540.064.046	BT40	ST6+	64	36	46	19	M16
134.550.020.063	BT50	ST1	20	11	63	25	M24
134.550.025.063	BT50	ST2	25	14	63	25	M24
134.550.032.065	BT50	ST3	32	18	65	27	M24
134.550.039.069	BT50	ST4	39	22	69	31	M24
134.550.050.072	BT50	ST5	50	28	72	34	M24
134.550.064.072	BT50	ST6+	64	36	72	34	M24
134.550.090.086	BT50	ST7+	90	46	86	48	M24

备件

锁紧尺寸	锁紧螺钉①	O-型圈②	膨胀螺钉③	螺纹圈④
ST1	900.100.004.005	900.101.008.002	-	-
ST2	900.100.005.006	900.101.011.002	-	-
ST3	900.100.006.008	900.101.015.002	-	-
ST4	900.100.008.011	900.101.019.002	-	-
ST5	900.100.010.012	900.101.025.002	-	-
ST6	900.100.012.018	900.101.032.002	-	-
ST6+	900.100.012.018	900.101.032.002	900.102.018.040	900.103.030.020
ST7+	900.100.020.029	900.101.043.002	900.102.024.045	900.103.040.020

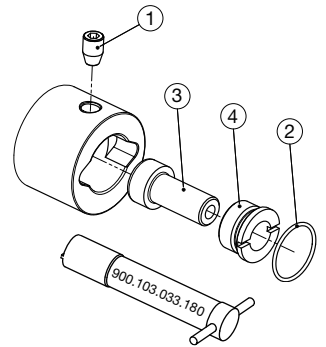

SwissBore164

延长刀柄

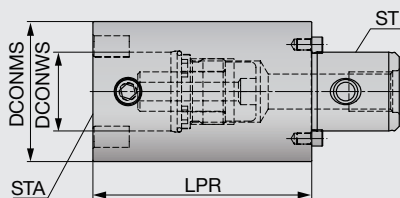

型号	ST	STA	DCONMS	DCONWS	LPR
164.020.020.020	ST1	ST1	20	11	20
164.020.020.030	ST1	ST1	20	11	30
164.025.025.030	ST2	ST2	25	14	30
164.025.025.045	ST2	ST2	25	14	45
164.032.032.030	ST3	ST3	32	18	30
164.032.032.045	ST3	ST3	32	18	45
164.039.039.040	ST4	ST4	39	22	40
164.039.039.060	ST4	ST4	39	22	60
164.050.050.060	ST5	ST5	50	28	60
164.050.050.090	ST5	ST5	50	28	90
164.064.064.060	ST6+	ST6+	64	36	60
164.064.064.100	ST6+	ST6+	64	36	100
164.090.090.100	ST7+	ST7+	90	46	100
164.090.090.160	ST7+	ST7+	90	46	160

选装配件：膨胀螺钉 & ST+ 型螺纹圈

备件



锁紧尺寸	锁紧螺钉①	O-型圈②	膨胀螺钉③	螺纹圈④	驱动栓⑤
ST1	900.100.004.005	900.101.008.002	-	-	900.102.020.000
ST2	900.100.005.006	900.101.011.002	-	-	900.102.025.000
ST3	900.100.006.008	900.101.015.002	-	-	900.102.032.000
ST4	900.100.008.011	900.101.019.002	-	-	900.102.039.000
ST5	900.100.010.012	900.101.025.002	-	-	900.102.050.000
ST6	900.100.012.018	900.101.032.002	-	-	900.102.064.000
ST6+	900.100.012.018	900.101.032.002	900.102.018.040	900.103.030.020	900.102.064.000
ST7+	900.100.020.029	900.101.043.002	900.102.024.045	900.103.040.020	900.102.090.000

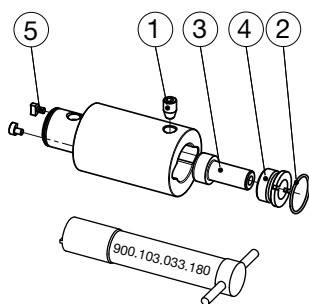

SwissBore184

减径刀柄

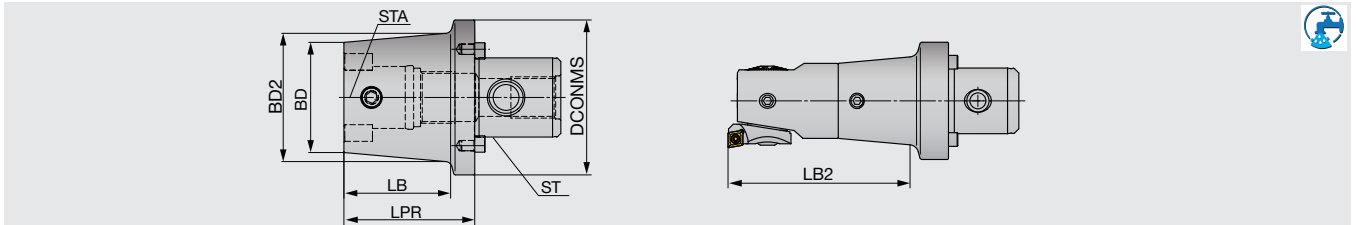

型号	ST	STA	DCONMS	BD	BD2	LPR	LB	LB2
184.025.020.036	ST2	ST1	25	20	23	36	25	60.5
184.032.025.034	ST3	ST2	32	25	29	34.5	20	60
184.039.032.047	ST4	ST3	39	32	38	47	35	82
184.050.039.040	ST5	ST4	50	39	48	40	25.5	82.5
184.064.050.039	ST6+	ST2	64	50	60	39	24	104

BL2：双锥头或精锥头最大镗孔深度
选装配件：膨胀螺钉 & ST+ 型螺纹圈

备件

锁紧尺寸	锁紧螺钉①	O-型圈②	膨胀螺钉③	螺纹圈④	驱动栓⑤
ST1	900.100.004.005	900.101.008.002	-	-	900.102.020.000
ST2	900.100.005.006	900.101.011.002	-	-	900.102.025.000
ST3	900.100.006.008	900.101.015.002	-	-	900.102.032.000
ST4	900.100.008.011	900.101.019.002	-	-	900.102.039.000
ST5	900.100.010.012	900.101.025.002	-	-	900.102.050.000
ST6	900.100.012.018	900.101.032.002	-	-	900.102.064.000
ST6+	900.100.012.018	900.101.032.002	900.102.018.040	900.103.030.020	900.102.090.000

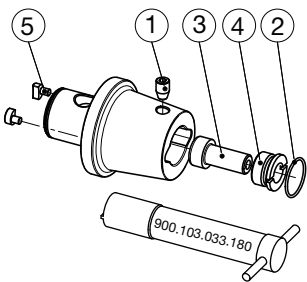

带数字显示屏的精镗头

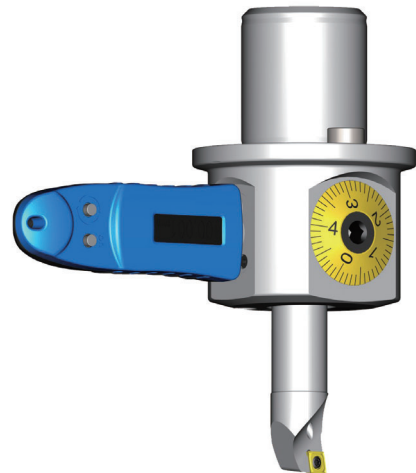

带有高精度调节机构的精镗头系统

- 使在机床上进行直径 $1 \mu\text{m}$ 的调节量变得简单和精确
- 数显单元固定在镗刀头上实现微量调节
- 经济型数显单元可与所有精镗头一起使用。
- 内冷实现顺畅的排屑
- 也可用于连接 TungCap 接口，可应用在多任务机床上

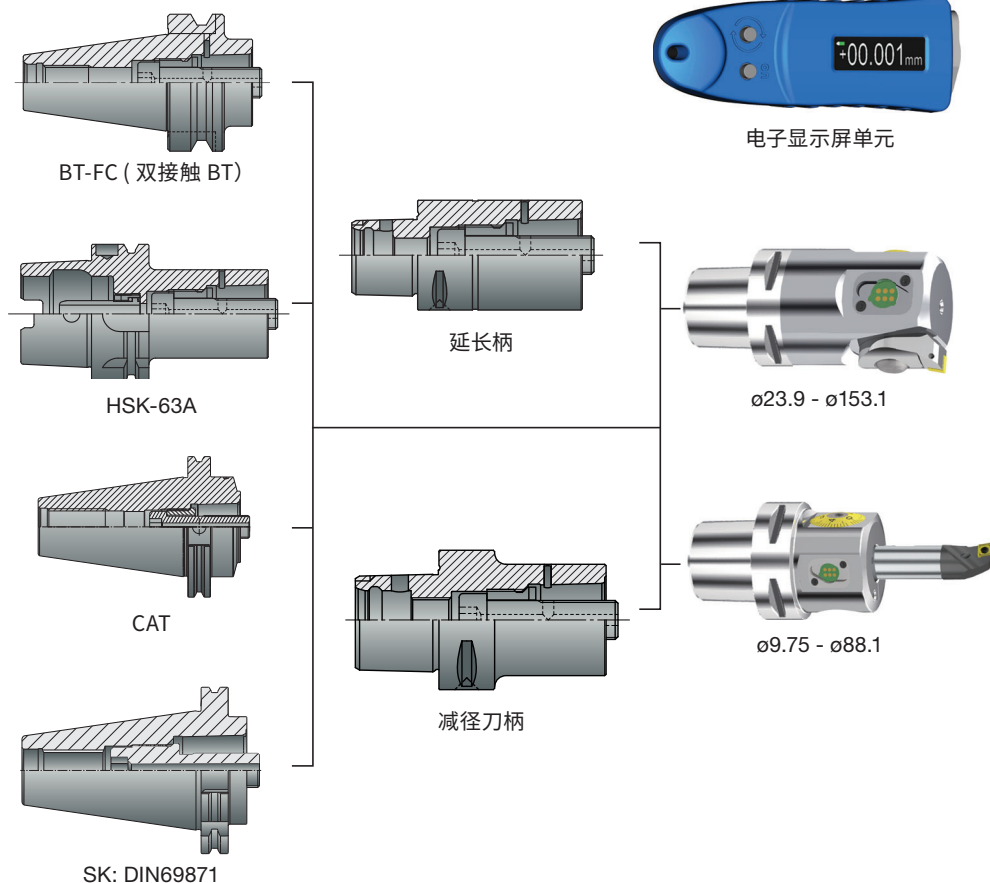

TungCap FBHO-DE

带数显的精镗头 $\phi 9.75 - \phi 88.1$

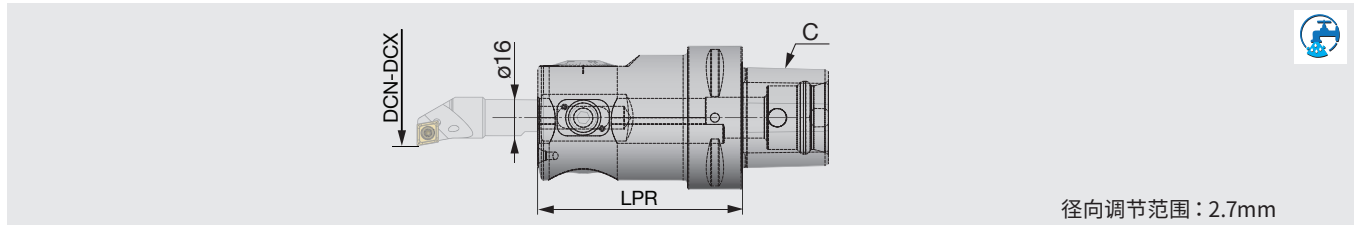

径向调节范围：2.7mm

型号	C	DCN	DCX	LPR	镗刀杆
BT4-FBHO-DE-1690	BT40	9.75	88.1	90	254.0**006... / 256...
HA6-FBHO-DE-1695	HSK-A63	9.75	88.1	95	254.0**006... / 256...
PSC63-FBHO-DE-1690	C6	9.75	88.1	90	254.0**006... / 256...
PSC50-FBHO-DE-1670	C5	9.75	88.1	70	254.0**006... / 256...
PSC40-FBHO-DE-1665	C4	9.75	88.1	65	254.0**006... / 256...

适用于 7MPa 的高压冷却

TungCap FBHS-DE

带数显的精镗头 $\phi 23.9 - \phi 153.1$

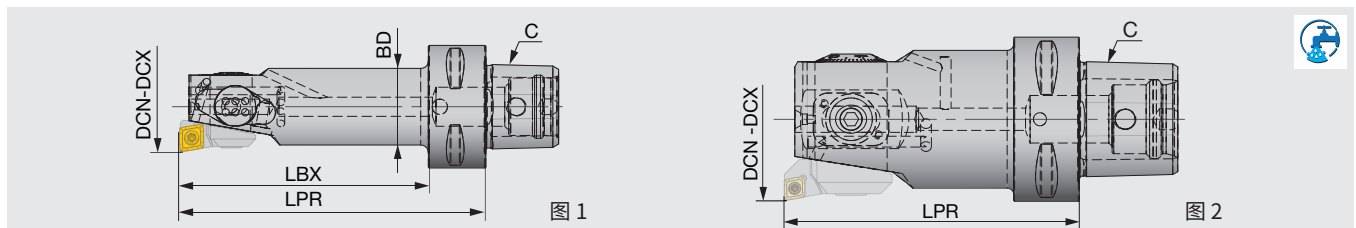

型号	C	DCN	DCX	LPR	LBX	BD	图.	镗头
PSC32-FBHS-DE-24	C3	23.9	31.1	80	65	20	1	314.011.024.006/007
PSC32-FBHS-DE-24	C3	29.9	37.1	80	65	20	1	314.011.030.006/007
PSC32-FBHS-DE-31	C3	30.9	40.1	90	75	25	1	314.013.031.006/007
PSC32-FBHS-DE-31	C3	37.5	47.1	90	75	25	1	314.013.038.006/007
PSC40-FBHS-DE-40	C4	39.9	51.1	90	70	32	1	314.017.040.006/007
PSC40-FBHS-DE-40	C4	47.5	59.1	90	70	32	1	314.017.048.006/007
PSC50-FBHS-DE-51	C5	50.9	67.1	90	-	-	2	314.022.051.006/007
PSC50-FBHS-DE-51	C5	64.9	81.1	90	-	-	2	314.022.065.006/007
PSC50-FBHS-DE-67	C5	66.9	87.1	100	-	-	2	314.030.067.009/011
PSC50-FBHS-DE-67	C5	84.9	105.1	100	-	-	2	314.030.085.009/011
PSC63-FBHS-DE-87	C6	86.9	116.1	120	-	-	2	314.030.067.009/011
PSC63-FBHS-DE-87	C6	104.9	134.1	120	-	-	2	314.030.085.009/011
PSC63-FBHS-DE-116	C6	115.9	153.1	150	-	-	2	314.030.067.009/011
PSC63-FBHS-DE-116	C6	133.9	171.1	150	-	-	2	314.030.085.009/011

镗头不包括在内
适用于 7MPa 的高压冷却

总公司 泰珂洛超硬工具(上海)有限公司

ADD: 上海市闸北区江场三路 88 号 401 室

TEL : 021-36321879 36321880

FAX : 021-36321918

大连分公司

ADD: 大连经济技术开发区铁山中路 62 号

TEL : 0411-87963170

FAX : 0411-87963141

广州分公司

ADD: 广州市番禺区沙头街禺山西路 329 号
4 座 1 栋 1410 单元

TEL : 020-38395085 38395116

FAX : 020-38395106

成都办事处

ADD: 四川省成都市高新区天府二街复城国际
广场 T4 栋 2701 号

TEL : 028-61500820

FAX : 028-61500821

天津分公司

ADD: 天津市河西区怒江道北侧创智东园
2 号楼 1007 室

TEL : 022-83709199

FAX : 022-83709198

西安办事处

ADD: 陕西省西安市高新区锦业一路 56 号
研祥城市广场 B 座 2028 号

TEL : 029-88861380

FAX : 029-88861379



www.tungaloy.com/cn

follow us at:

facebook.com/tungaloyjapan

twitter.com/tungaloyjapan

To see this product in action visit:

Tung-TV

www.youtube.com/tungaloycorporation

Distributed by:



DOWNLOAD
Dr. Carbide App



FIND US ON THE CLOUD!
machiningcloud.com



Available on the
App Store



GET IT ON
Google play



AS9100 Certified
78006
2015.11.04
ISO14001 Certified
EC97J1123
1997.11.26

Produced from Recycled paper

2018.12 (TJ)