



For more information

Grooving and profiling tool

TUNG ^{HEAVY} GROOVE

Tungaloy Report No. 427S1-G

New enhanced insert clamping system



Increased tool rigidity for heavy duty grooving applications

- A thick support material under the insert seat, combined with two-face contact design of the holder, provides extra tool stability during demanding operations with heavy cutting loads
- Internal coolant system with high pressure capability (with G1/8" connecting screw threads)



■ Comparison of toolholder stiffness

Tool deflection is reduced by more than 50%.



More than 50% higher rigidity!

HGM insert

- Pressed chipbreaker optimized for stable chip control
- Available in wear-resistant **T9215** CVD grade or versatile **AH8015** PVD grade

Chip control

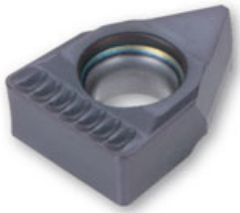

P Insert : HGM10-08 AH8015
 Workpiece material : S45C / C45
 Groove width : CW = 10 mm
 Groove depth : 30 mm
 Coolant : Wet (1MPa)

Cutting speed: Vc (m/min)	120					
	100					
	80					
		0.2	0.25	0.3	0.35	0.4
		Feed: f (mm/rev)				

INSERT AND HOLDER COMPATIBILITIES

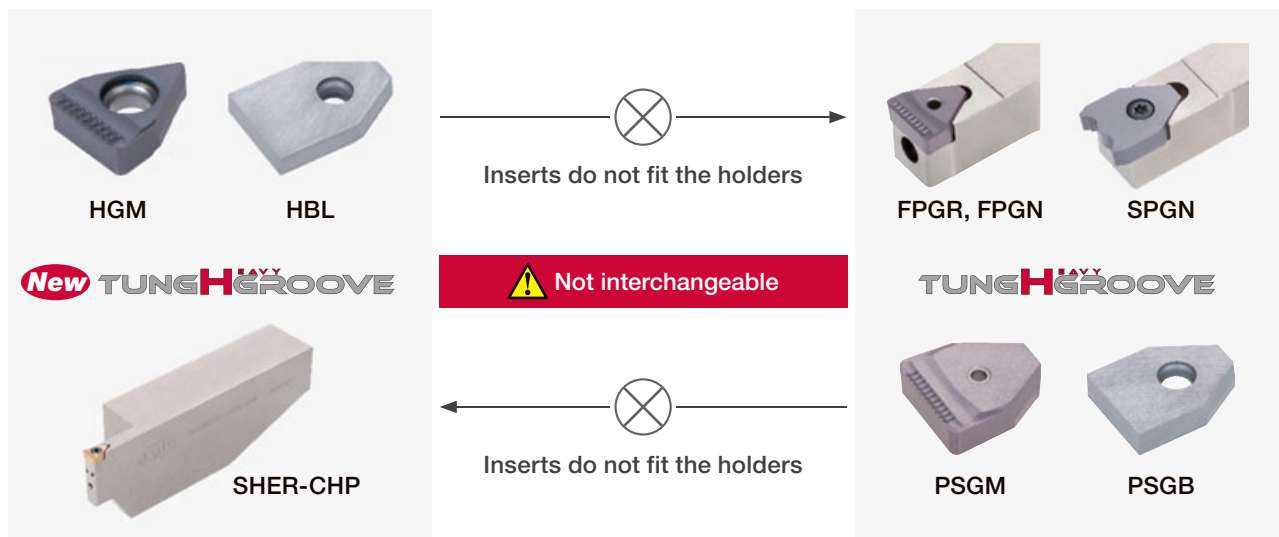

The new version of TungHeavyGroove is always the first choice. The previous version is recommended only when the tool-workpiece collision is anticipated.

TOOLHOLDER

SHER-CHP

Tube connection

External grooving and profiling toolholder, with high pressure coolant capability

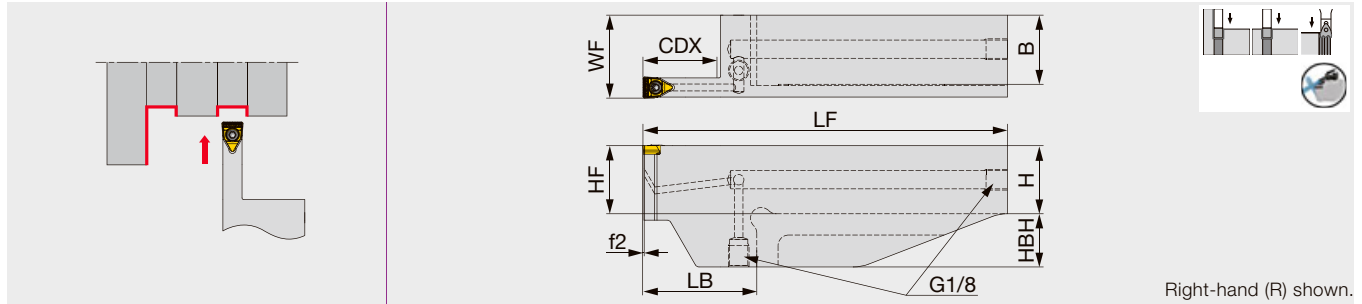

Designation	CW	CDX ⁽¹⁾	LB ⁽¹⁾	H	B	LF ⁽¹⁾	HF	WF	HBH	f2 ⁽¹⁾	Insert	Torque*
SHER2525-10T20-CHP	10	20	37.5	25	25.5	150	25	32	25	0.5	HGM10..., HBL10	3.5
SHER3232-10T36-CHP	10	36	53.5	32	32.5	170	32	39	25	0.5	HGM10..., HBL10	3.5
SHER2525-15T20-CHP	15	20	37.5	25	25.5	150	25	32	25	0.5	HGM15..., HBL15	5
SHER3232-15T40-CHP	15	40	57.5	32	32.5	170	32	39	25	0.5	HGM15..., HBL15	5
SHER3232-20T40-CHP	20	40	57.7	32	32.5	170	32	39	25	0.7	HGM20..., HBL20	7
SHER4040-20T50-CHP	20	50	67.7	40	40.5	180	40	47	25	0.7	HGM20..., HBL20	7
SHER3232-25T40-CHP	25	40	57.7	32	32.5	170	32	39	25	0.7	HGM25..., HBL25	7
SHER4040-25T50-CHP	25	50	67.7	40	40.5	180	40	47	25	0.7	HGM25..., HBL25	7

(1) The values for CDX, LB, LF, and f2 are true when HGM insert is assembled. Note that these values differs when HBL insert is assembled.
Torque*: Recommended clamping torque (N·m)

SPARE PARTS

Designation	Clamping screw	Wrench	Grip	Torx bit	Coolant plug
SHER**-10T...	CSTB-4S	T-15F	-	-	PLUGG1/8-6.5TL360
SHER**-15T...	CSTB-5S	T-20F	-	-	PLUGG1/8-6.5TL360
SHER**-20T..., 25T...	CSTB-6	-	H-TB2W	BLDT25/S7	PLUGG1/8-6.5TL360

CHIPBREAKER GUIDE

HGM



For wide grooving
Designed to provide stable chip control during high feed rate machining
CW = 10 - 25 mm

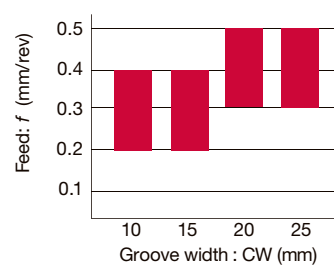

Feed: f (mm/rev)

Groove width : CW (mm)



INSERT

HGM

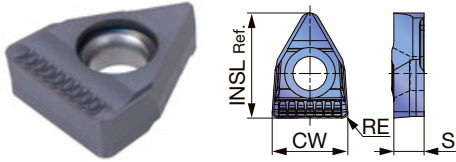

P	Steel	★	★						
M	Stainless	★	☆						
K	Cast iron	★	☆						
N	Non-ferrous								
S	Superalloys	★							
H	Hard materials								

★ : First choice
☆ : Second choice

Designation	CW±0.1	RE	Coated						INSL	S
			AH8015	T9215						
HGM10-08	10	0.8	●	●					13.9	4
HGM15-15	15	1.5	●	●					18	5
HGM20-20	20	2	●						22	6.5
HGM25-20	25	2	●						27	6.5

5 pieces per package
● : Line up

STANDARD CUTTING CONDITIONS

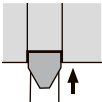

Wide grooving (HGM insert)

ISO	Workpiece material	Hardness	Priority	Grade	Cutting speed Vc (m/min)
P	Steel S45C, SCM435, etc. C45, 34CrMo4, etc.	< 300 HB	First choice	AH8015	80 - 180
		< 300 HB	Wear resistance	T9215	100 - 350
M	Stainless steel SUS303, SUS304, etc. X10CrNiS18-9, X5CrNi18-9, etc.	< 200 HB	First choice	AH8015	50 - 130
		< 200 HB	Wear resistance	T9215	100 - 250
K	Grey cast iron FC250, etc. 250, etc.	-	First choice	AH8015	50 - 180
		-	Wear resistance	T9215	140 - 300
K	Ductile cast iron FCD450, etc. 450-10S, etc.	-	First choice	AH8015	50 - 120
		-	Wear resistance	T9215	140 - 300
S	Superalloys Inconel718, etc.	< HRC 40	First choice	AH8015	20 - 80
		< HRC 40	First choice	AH8015	20 - 80
S	Titanium alloys Ti-6Al-4V, etc.	< HRC 40	First choice	AH8015	20 - 80

BLANK INSERT

HBL (Blank for wide profile grooving)

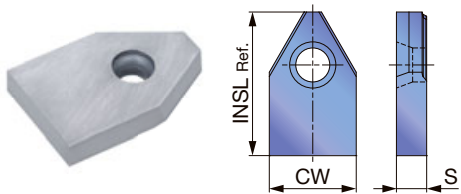

P	Steel	★							
M	Stainless	★							
K	Cast iron	★							
N	Non-ferrous	★							
S	Superalloys								
H	Hard materials								★ : First choice

Designation	CW±0.05	Uncoated						INSL	S
		TH10							
HBL10	11.5	●						19	4
HBL15	15.5	●						25	5
HBL20	20.5	●						30	6.5
HBL25	25.5	●						39	6.5

These are blanks (semi-finished products) for wide profile grooving inserts that can be tailored.

5 pieces per package

● : Line up

Customizable section of the blank

1 Customizable section of the blank is the part indicated by .

Excluding:

- The ring section enclosed between the outer circle of the screw hole and the circle **1.0 mm** larger in radius
- The triangular section for clamping and the section extended by **0.5 mm** towards the cutting edge

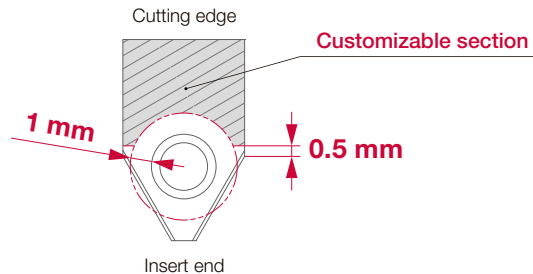

2 Requirement of additional modification

When the groove profile depth required exceeds the L1 value per in the right list, an additional modification may be required for the holder to avoid tool collision.

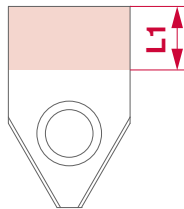

Designation	L1 (mm)
HBL10	6
HBL15	8.5
HBL20	8
HBL25	12

- Custom shaped inserts can be requested based on customers part drawing specifications
- Semi-finished blanks HBL types are offered for purchase

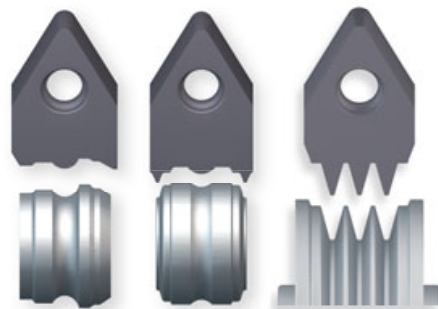

Tungaloy Corporation (Head office)

11-1 Yoshima-Kogyodanchi
Iwaki-city, Fukushima 970-1144 Japan
Phone: +81-246-36-8501
Fax: +81-246-36-8542
www.tungaloy.co.jp

Tungaloy-NTK America Inc.

3726 N Ventura Drive
Arlington Heights, IL 60004, U.S.A.
Phone: +1-888-554-8394
Fax: +1-888-554-8392
www.tungaloy.com/us

Tungaloy Canada

432 Elgin St. Unit 3
Brantford, Ontario N3S 7P7, Canada
Phone: +1-519-758-5779
Fax: +1-519-758-5791
www.tungaloy.com/ca

Tungaloy-NTK De Mexico S.A.

C. Los Arellano 113,
Parque Industrial Siglo XXI
Aguascalientes, AGS, Mexico 20290
Phone: +52-449-929-5410
Fax: +52-449-929-5411
www.tungaloy.com/mx

Tungaloy-NTK do Brasil Ltda.

Avd. Independencia N4158 Residencial Flora
13280-000 Vinhedo, São Paulo, Brasil
Phone: +55-19-38262757
Fax: +55-19-38262757
www.tungaloy.com/br

Tungaloy-NTK Germany GmbH.

Katzbergstr. 3a
D-40764 Langenfeld, Germany
Phone: +49-2173-90420-0
Fax: +49-2173-90420-19
www.tungaloy.com/de

Tungaloy France s.a.s

Les Fjords
19 avenue de Norvège
91140 Villebon Sur Yvette, France
Phone: +33-1-6486-4300
Fax: +33-1-6907-7817
www.tungaloy.com/fr

Tungaloy Italia S.r.l.

Via E. Andolfato 10
I-20126 Milano, Italy
Phone: +39-02-252012-1
Fax: +39-02-252012-65
www.tungaloy.com/it

Tungaloy Czech s.r.o.

Turanka 115
CZ-627 00 Brno, Czech Republic
Phone: +420-532 123 391
Fax: +420-532 123 392
www.tungaloy.com/cz

Tungaloy Ibérica S.L.

C/Miquel Servet, 43B, Nau 7
Pol. Ind. Bufalvent
ES-08243 Manresa (BCN), Spain
Phone: +34 93 113 1360
Fax: +34 93 876 2798
www.tungaloy.com/es

Tungaloy Scandinavia AB

Bultgatan 38
442 40 Kungälv, Sweden
Phone: +46-462119200
Fax: +46-462119207
www.tungaloy.com/se

Tungaloy Rus, LLC

Andropova avenue, h.18/7,
11 floor, office 3, 115432,
Moscow, Russia
Phone: +7-499-683-01-80
Fax: +7-499-683-01-81
www.tungaloy.com/ru

Tungaloy Polska Sp. z o.o.

Ul. Irysowa 1, 55-040 Bielany
Wroclawskie, Poland
Phone: +48 607 907 237
www.tungaloy.com/pl

Tungaloy-NTK UK Ltd.

Suite 3, Pioneer House, Mill Street,
Cannock, WS11 0EF, UK
Phone: +44 121 4000 231
Fax: +44 121 270 9694
www.tungaloy.com/uk

Tungaloy Hungary Kft

Erzsébet királyné útja 125
H-1142 Budapest, Hungary
Phone: +36 1 781-6846
Fax: +36 1 781-6866
www.tungaloy.com/hu

Tungaloy Turkey

Serifali Mah.bayraktar Bulvari Kule Sk. No:26
34775 Umraniye / Istanbul / Turkey
Phone: +90 216 540 04 67
Fax: +90 216 540 04 87
www.tungaloy.com/tr

Tungaloy Benelux b.v.

Tjalk 70
NL-2411 NZ Bodegraven, Netherlands
Phone: +31 172 630 420
Fax: +31 172 630 429
www.tungaloy.com/nl

Tungaloy Croatia

Ulica bana Josipa Jelačića 87,
10430, Samobor, Croatia
Phone: +385 1 3326 604
Fax: +385 1 3327 683
www.tungaloy.com/hr

Tungaloy Cutting Tool (Shanghai) Co. Ltd.

Rm No 401 No.88 Zhabei
Jiangchang No.3 Rd
Shanghai 200436, China
Phone: +86-21-3632-1880
Fax: +86-21-3621-1918
www.tungaloy.com/cn

Tungaloy Cutting Tools Taiwan Co. Ltd.

9F, No.293, Zhongyang Rd,
Xinzhuan Dist, New Taipei City,
24251 Taiwan
Phone: +886-2-8521-9986
Fax: +886-2-8521-8935
www.tungaloy.com/tw

Tungaloy-NTK Cutting Tool (Thailand) Co.,Ltd.

Interlink tower 4th Fl.
1858/5-7 Bangna-Trad Road
km.5 Bangna, Bangna, Bangkok 10260
Thailand
Phone: +66-2-751-5711
Fax: +66-2-751-5715
www.tungaloy.com/th

Tungaloy Singapore (Pte.), Ltd.

62 Ubi Road 1, #06-11 Oxley BizHub 2
Singapore 408734
Phone: +65-6391-1833
Fax: +65-6299-4557
www.tungaloy.com/sg

Tungaloy Vietnam

LE04.38, Lexington Residence
67 Mai Chi Tho St., Dist. 2,
Ho Chi Minh City, Vietnam
Phone: +84-2837406660
www.tungaloy.com/sg

Tungaloy India Pvt. Ltd.

One International Center,
Unit # 902-A, 9th Floor,
Tower 1, Senapati Bapat Marg,
Elphinstone Road (West),
Mumbai 400013, India
Phone: +91-22-6124-8803
Fax: +91-22-6124-8899
www.tungaloy.com/in

Tungaloy Korea Co., Ltd

#1312, Byucksan Digital Valley 5-cha
Beotkkot-ro 244, Geumcheon-gu
153-788 Seoul, Korea
Phone: +82-2-2621-6161
Fax: +82-2-6393-8952
www.tungaloy.com/kr

Tungaloy Malaysia Sdn Bhd

50 K-2, Kelana Mall, Jalan SS6/14
Kelana Jaya, 47301
Petaling Jaya, Selangor Darul Ehsan
Malaysia
Phone: +603-7805-3222
Fax: +603-7804-8563
www.tungaloy.com/my

Tungaloy Australia Pty Ltd

Unit 68 1470 Ferntree Gully Road
Knoxfield 3180 Victoria, Australia
Phone: +61-3-9755-8147
Fax: +61-3-9755-6070
www.tungaloy.com/au

PT. Tungaloy Indonesia

Ruko Blok AA.10 No3&5, Grand Wisata,
Lembangjaya, Tambun Selatan, Bekasi,
17510 Indonesia
Phone: +62-21-8261-5808
Fax: +62-21-8261-5809
www.tungaloy.com/id



tungaloy.com

follow us at:

facebook.com/tungaloyjapan

twitter.com/tungaloyjapan

www.youtube.com/tungaloycorporation

Distributed by:



Tungaloy APP & SNS

FIND US ON THE CLOUD!
machingcloud.com



AS9100 Certified
78006
2015.11.04
ISO 14001 Certified
EC97J1123
1997.11.26